

# OUTSTANDING QUALITY FOR DEMANDING APPLICATIONS



SUITABLE FOR NEARLY EVERY APPLICATION

HIGH QUALITY AND RELIABILITY

GOOD BALANCE IN TERMS OF CAPACITY AND LIFETIME

EXCELLENT DISCHARGE CHARACTERISTICS

Scan QR code  
to view product  
series video.

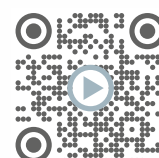

## BATTERY TYPES AND MODEL NUMBERS

Application	Series	Trickle design life (at 20°C)	Category	Standard ABS (UL94 HB)	FR ABS = Flame-retardant ABS (UL94 V-0)
Back-up and main power	LC-R/RA	6 – 9 years	Trickle and cycle standard type	○	
Back-up	LC-P/PA/PB	10 – 12 years	Trickle long-life type		○
	LC-QA	15 years	Trickle super long-life type		○
	LC-V/VA	6 – 9 years	Trickle standard type		○
	LC-X/XD/XB	10 – 12 years	Trickle long-life type	○	
	UP-PW	10 – 12 years	High power long-life type		○
	UP-VW/VWA	6 – 9 years	High power type		○
Main power	LC-CA/XC	-	Cycle long-life type	○	
	LC-T	-	Cycle long-life type for energy storage	○	
Motive and hybrid	EC-FV/HV	-	Cycle long-life type for motive power	*1	*1



## LC SERIES

The Panasonic LC series is a comprehensive range of high quality VRLA batteries serving the majority of VRLA battery applications. From batteries with a trickle design life of 6 – 9 years and 10 – 12 years to batteries of 15 years, the series includes solutions for every requirement. Various models are obtainable with flame-retardant housing and with different terminals.

## FEATURES

- State-of-the-art Absorbed Glass Mat (AGM) technology
- Superior design and low voltage spread
- Enhanced lifespan due to excellent recombination efficiency
- Highest quality control standards
- Almost 50 years of experience in production
- Selected batteries with flame-retardant battery containers according to UL94 V-0
- Various VdS approved batteries

## APPLICATIONS

- UPS
- Energy storage
- Communication infrastructure
- Wind turbines (pitch system)
- Alarm systems
- Medical equipment
- Emergency lights, etc.

## LC SERIES – TRICKLE DESIGN LIFE 6 – 9 YEARS

## MODEL NUMBER (EXAMPLE)

## LC - R 1 2 1 R 3 P G

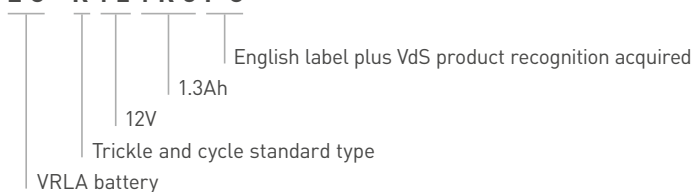

## LC - V 1 2 3 3 P

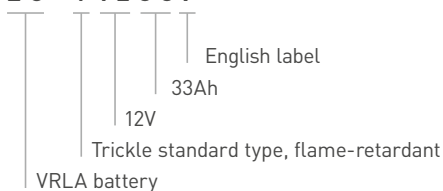

Model number	Nominal voltage (V)	Nominal capacity (Ah) 20 hours rate	Length (mm)	Width (mm)	Total height (mm)	Weight (kg)	VdS number
LC-R061R3P	6	1.3	24.0	97.0	55.0	0.3	-
LC-R063R4P	6	3.4	34.0	134.0	66.0	0.6	-
LC-R064R5P	6	4.5	48.0	70.0	108.0	0.7	-
LC-R067R2P	6	7.2	34.0	151.0	100.0	1.3	-
LC-R0612P	6	12.0	50.0	151.0	100.0	2.0	-
LC-R121R3PG*1	12	1.3	47.5	97.0	55.0	0.6	G196049
LC-R122R2PG*1	12	2.2	34.0	177.0	66.0	0.8	G188151
LC-R123R4PG*1	12	3.4	67.0	134.0	66.0	1.2	G191053
LC-R124R5P*1	12	4.5	70.0	97.0	108.0	1.5	-
LC-R127R2PG/PG1*1	12	7.2	64.5	151.0	100.0	2.5	G193046
LC-RA1212PG/PG1*1	12	12.0	98.0	151.0	100.0	3.8	G100001
LC-RA1215P/P1*1	12	15.0	98.0	151.0	100.0	4.2	-
LC-V1233P	12	33.0	130.0	195.6	180.0	11.1	-

## LC SERIES – TRICKLE DESIGN LIFE 10-12 YEARS

### MODEL NUMBER (EXAMPLE)

#### LC - X D 1 2 1 7 A P G

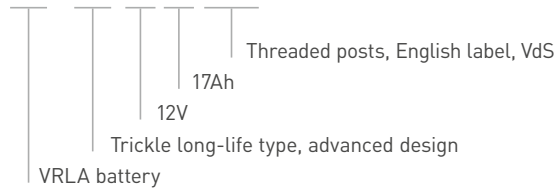

#### LC - X 1 2 6 5 P G

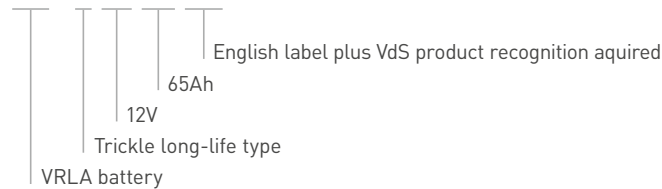

Model number	Nominal voltage (V)	Nominal capacity (Ah) 20 hours rate	Length (mm)	Width (mm)	Total height (mm)	Weight (kg)	VdS number
LC-P067R2P/P1	6	7.2	34.0	151.0	100.0	1.3	-
LC-P0612P/P1	6	12.0	50.0	151.0	100.0	2.0	-
LC-P06200TA	6	200.0	173.0	407.0	250.0	41.0	-
LC-P122R2P	12	2.2	34.0	177.0	66.0	0.8	-
LC-P123R4P	12	3.4	67.0	134.0	66.0	1.2	-
LC-P127R2P/P1	12	7.2	64.5	151.0	100.0	2.5	-
LC-PA1212P/P1	12	12.0	98.0	151.0	100.0	3.7	-
LC-PA1216P/P1	12	16.0	98.0	151.0	105.0	4.1	-
LC-XD1217PG/APG	12	17.0	76.0	181.0	167.0	5.9	G104101
LC-P1220P/AP	12	20.0	76.0	181.0	167.0	6.6	-
LC-P1224P/APG	12	24.0	125.0	165.0	179.5/175.0	9.0	G198049
LC-P1228P/AP	12	28.0	125.0	165.0	179.5/175.0	11.0	-
LC-P1238PG/APG	12	38.0	165.0	197.0	180.0/175.0	13.0	G100002

\*1 This battery is also available with a flame-retardant battery case resin (UL94 V-0).

Model number	Nominal voltage (V)	Nominal capacity (Ah) 20 hours rate	Length (mm)	Width (mm)	Total height (mm)	Weight (kg)	VdS number
LC-P1242P/AP	12	42	165.0	197.0	180.0/175.0	13.5	-
LC-X1265PG	12	65	166.0	350.0	175.0	23.5	G199090
LC-P1265PG	12	65	166.0	350.0	175.0	20.0	G199090
LC-P1275P	12	75	166.0	350.0	175.0	24.0	-
LC-XB12100P	12	100	173.0	407.0	236.0	36.5	-
LC-PB12100P	12	100	173.0	407.0	236.0	36.5	-
LC-P12120P	12	120	173.0	407.0	236.0	34.5	-
LC-P12150BP*1	12	150	183.0	532.0	214.0	43.0	-
LC-P12200BP*1	12	200	237.0	533.0	216.0	57.0	-



## LC CYCLIC SERIES

The Panasonic LC cyclic series is a main power source for electrical devices which require reliable power frequently. Based on our proven technology for stand-by and occasional back-up, this series uses different plate design and other tweaks to achieve long cycle life.

### FEATURES

- State-of-the-art Absorbed Glass Mat (AGM) technology
- Superior design and low voltage spread gives excellent performance
- Enhanced lifespan due to low and stable charge current
- 100% inspection after final assembly and before shipment
- Years of experience in production
- Selected batteries with flame-retardant battery containers according to UL94 V-0
- Various VdS approved batteries

### APPLICATIONS

- Solar street lighting
- Medical equipment
- Lawn mowers
- Automated guided vehicles
- Wheelchairs, etc.

## LC CYCLIC – CYCLE LONG-LIFE AND CYCLE LONG-LIFE FOR ENERGY STORAGE

### MODEL NUMBER (EXAMPLE)

#### LC - CA 12 16 P

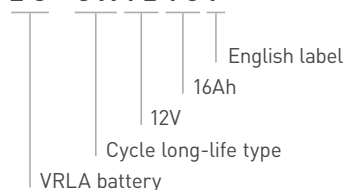

Model number	Nominal voltage (V)	Nominal capacity (Ah) 20 hours rate	Length (mm)	Width (mm)	Total height (mm)	Weight (kg)	VdS number
LC-CA1212P/P1	12	12	98.0	151.0	100.0	3.8	-
LC-CA1215P/P1	12	15	98.0	151.0	100.0	4.2	-
LC-CA1216P/P1	12	16	98.0	151.0	105.0	4.7	-
LC-XC1222P/AP	12	22	76.0	181.0	167.0	6.6	-
LC-XC1228P/AP	12	28	125.0	165.0	179.5	10.0	-
LC-XC1238P/AP	12	38	165.0	197.0	179.5	15.0	-
LC-T1270P*2	12	70	166.0	350.0	175.0	24.5	-
LC-T12105P*2	12	105	173.0	407.0	236.0	34.0	-

\*1 This battery is equipped with insert terminals.

\*2 This battery type is designed for energy storage applications.



## LC-QA SERIES – TRICKLE DESIGN LIFE 15 YEARS

The hallmarks of the Panasonic LC-QA battery series are a very long service life of 15 years (at 20°C) and excellent product quality. The latest LC-QA models are the result of a research programme to prolong the service life of lead-acid batteries, which Panasonic started back in 1984.

### FEATURES

- ☐ Innovative Lead-Calcium-Tin alloy minimises harmful corrosion to the positive electrode
- ☐ Reliable seal thanks to a rubber washer and epoxy resin
- ☐ Flame-retardant housing according to UL 94-V0

### APPLICATIONS

- ☐ Mainly telecommunications industry
- ☐ Emergency light for trains
- ☐ UPS systems
- ☐ Energy distribution, etc.

### MODEL NUMBER (EXAMPLE)

#### LC - QA 12 24 AP

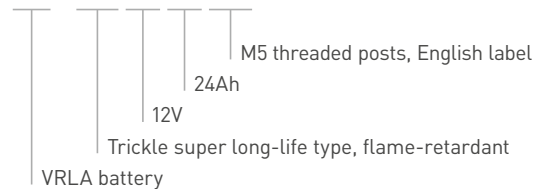

Model number	Nominal voltage (V)	Nominal capacity (Ah) 20 hours rate	Length (mm)	Width (mm)	Total height (mm)	Weight (kg)	VdS number
LC-QA06210TP	6	210	173.0	407.0	250.0	36.5	-
LC-QA1224P/AP	12	24	125.0	165.0	175.0	10.0	-
LC-QA1242P	12	42	165.0	197.0	180.0	13.5	-
LC-QA1270P	12	70	166.0	350.0	175.0	23.5	-
LC-QA12110TP	12	110	173.0	407.0	236.0	36.0	-



## UP-VW / -PW SERIES – TRICKLE DESIGN LIFE 6–9 AND 10–12 YEARS

The Panasonic UP-VW / -PW series offers up to 30% higher energy density compared to conventional VRLA batteries with the same dimensions. The series is ideal for UPS systems which require a short discharge time of about 30 minutes or less.

### FEATURES

- ☐ 30% higher energy density compared to conventional VRLA batteries
- ☐ Superior quality
- ☐ 100% inspection after final assembly and before shipment
- ☐ Years of experience in production
- ☐ Batteries with flame-retardant battery container according to UL94 V-0

### APPLICATIONS

- ☐ UPS systems
- ☐ Servers, etc.

### MODEL NUMBER (EXAMPLE)

#### UP - PW 12 45 P

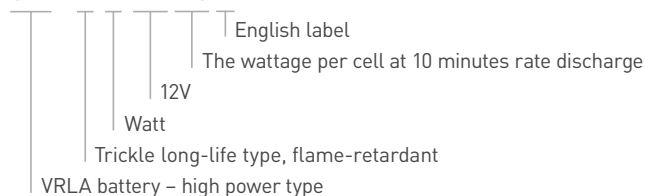

## VALVE-REGULATED-LEAD-ACID (VRLA)

### UP - VW 1220J1

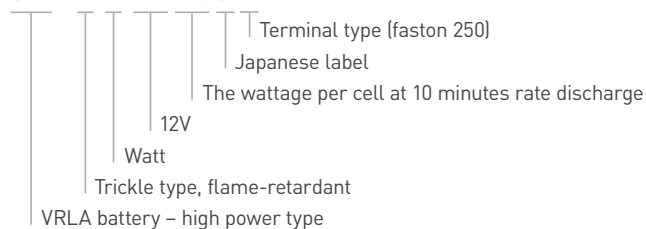

Model number	Nominal voltage (V)	Rated power (W) 10 minutes rate	Length (mm)	Width (mm)	Total height (mm)	Weight (kg)	VdS number
UP-VW0645P1	6	135	34.0	151.0	100.0	1.3	-
UP-VW1220P1	12	120	38.5	140.0	100.0	1.4	-
UP-VWA1232P1/P2	12	192	51.0	151.0	100.0	2.0	-
UP-VW1228P1	12	200	64.5	151.0	100.0	1.9	-
UP-VW1236P1	12	224	64.5	151.0	100.0	2.1	-
UP-VW1245P1	12	270	64.5	151.0	100.0	2.6	-
UP-PW1245P1	12	270	64.5	151.0	100.0	2.6	-



## EV SERIES – CYCLE VERY LONG-LIFE FOR MOTIVE POWER

The Panasonic EV series is designed specifically for electric vehicles and long-term cyclic applications. In both cases, the high cycle stability is a particular highlight, achieved in a recommended 5-step charging procedure.

### FEATURES

- ☐ High capacity
- ☐ Designed for deep discharges
- ☐ Extraordinary cycle stability
- ☐ Excellent discharge characteristics at low temperatures and high currents

### APPLICATIONS

- ☐ Golf buggies
- ☐ Mobile floor sweepers
- ☐ Solar or wind powered street lighting and advertising displays, etc.

### MODEL NUMBER (EXAMPLE)

#### EC - FV 1238

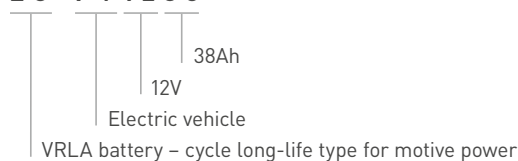

Model number	Nominal voltage (V)	Nominal capacity (Ah) 20 hours rate	Length (mm)	Width (mm)	Total height (mm)	Weight (kg)	VdS number
EC-FV0890B1E	8	90	116.0	388.0	175.0	22.0	-
EC-FV1238	12	38	116.0	261.0	175.0	14.0	-
EC-HV1255	12	55	116.0	388.0	175.0	22.0	-
EC-FV1260	12	60	116.0	388.0	175.0	21.0	-

### 3D ILLUSTRATION<sup>\*1</sup>

- 1 Negative plate terminal
- 2 Seals
- 3 Positive plate terminal
- 4 Battery case
- 5 Positive electrode
- 6 Separator
- 7 Negative electrode
- 8 Valve

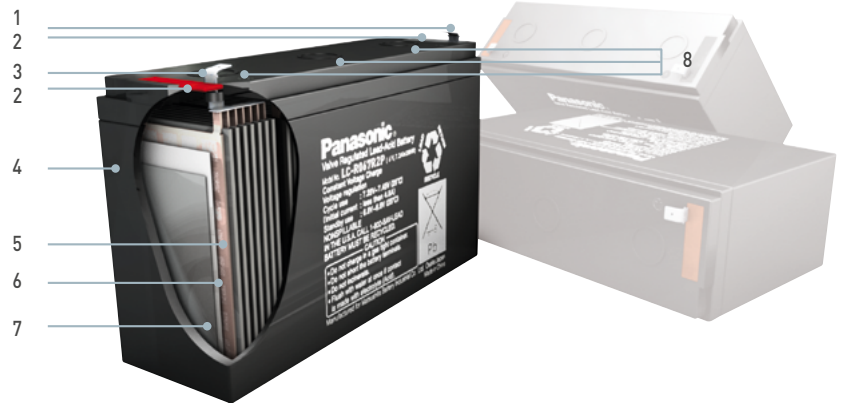

Scan QR code  
to view 3D  
animated video.

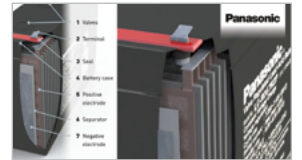

### TERMINAL TYPES

Panasonic offers the appropriate terminal type for each VRLA battery depending on the technical prerequisites. Additionally, some battery types are available with different terminal alternatives.

#### FASTON TAB TYPE 187 (P)

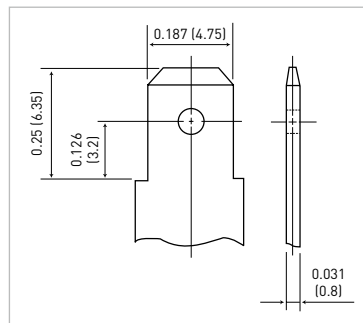

#### FASTON TAB TYPE 250 (P1)

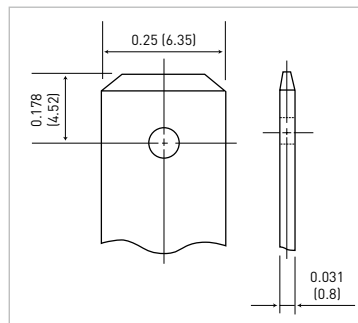

#### M5 THREADED POST TYPE (AP)

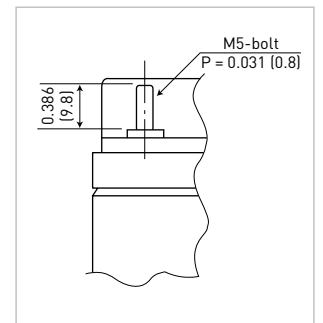

#### T-SHAPE TERMINAL (M10) (T)

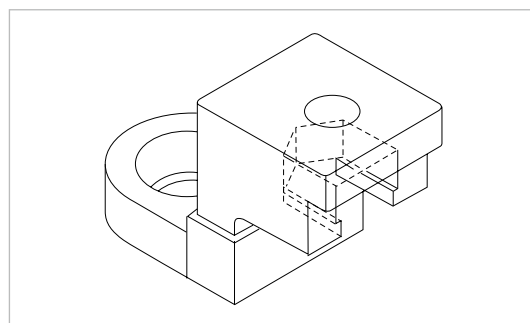

#### L-SHAPE TERMINAL (M5, 6, 8) (BOLT & NUT) (P)

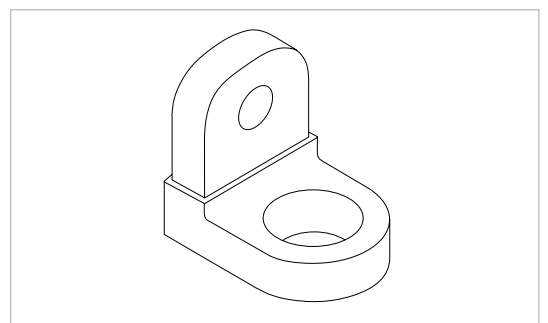

Unit: inch (mm)

<sup>\*1</sup> The illustration shows only one example of VRLA battery structure.